

IDENTIFICATION CERTIFICATE  
 RIVER STREET, EIGHTH AVENUE  
 IN THE AREA NAMED  
**ST PETERS**  
 HUNDRED OF ADELAIDE

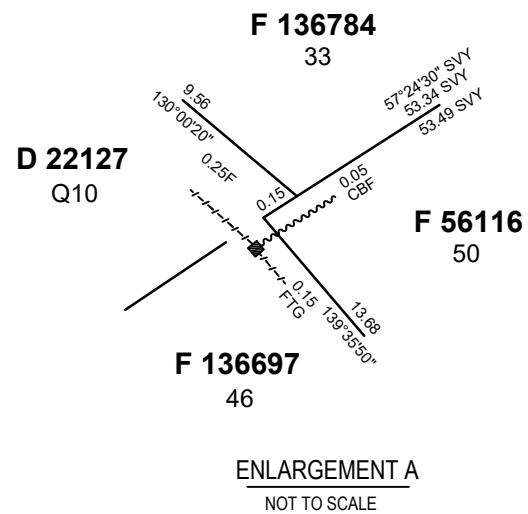
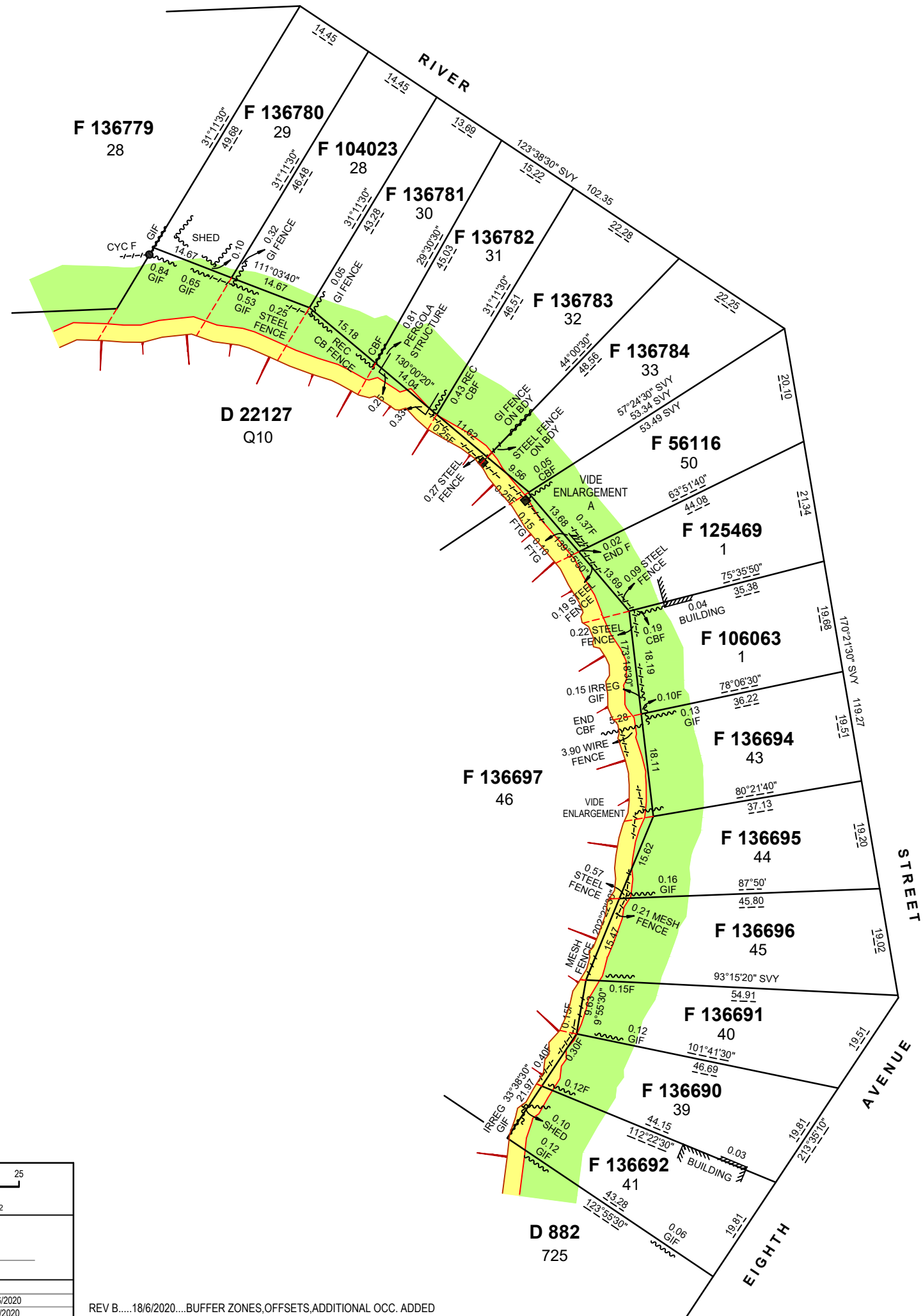
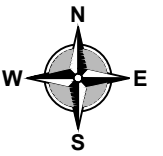

TOP OF BANK  
 DENOTES 3m WIDE BUFFER  
 DENOTES 10m WIDE BUFFER

Alexander & Symonds Pty Ltd  
 11 King William Street Kent Town,  
 South Australia 5067  
 PO Box 1000 Kent Town, SA 5071  
 DX 209 ABN 93007 753 988

T (08) 8130 1666  
 F (08) 8362 0099  
 W www.alexander.com.au  
 E adelaide@alexander.com.au

+ Property + Land Development +  
 + Construction + Mining +  
 + Spatial Information Management +



**LEGEND**

- MN Denotes MASONRY NAIL
- MP Denotes METAL PIN
- SPK Denotes SPIKE
- CB Denotes COLORBOND
- FD Denotes FOUND
- CT Denotes CERTIFICATE OF TITLE
- F Denotes FENCE
- GI Denotes GALVANISED IRON
- BDY Denotes BOUNDARY
- SVY Denotes SURVEY
- 46.89 Denotes COPIED DATA

BOUNDARY DEFINITION IN ACCORDANCE WITH SURVEY  
 MARKS FOUND IN F56116

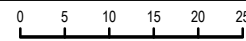

SCALE 1:500 METRES  
 AT ORIGINAL SHEET SIZE B2

**KANE RYAN**  
 LICENSED SURVEYOR

REF: A095019IDENT(B)  
 SURVEYED: KBR 15/10/2019 MJF 6/06/2020  
 DRAFTER: PAP 24/10/2019 PAP 18/06/2020

REV B.....18/6/2020....BUFFER ZONES, OFFSETS, ADDITIONAL OCC. ADDED

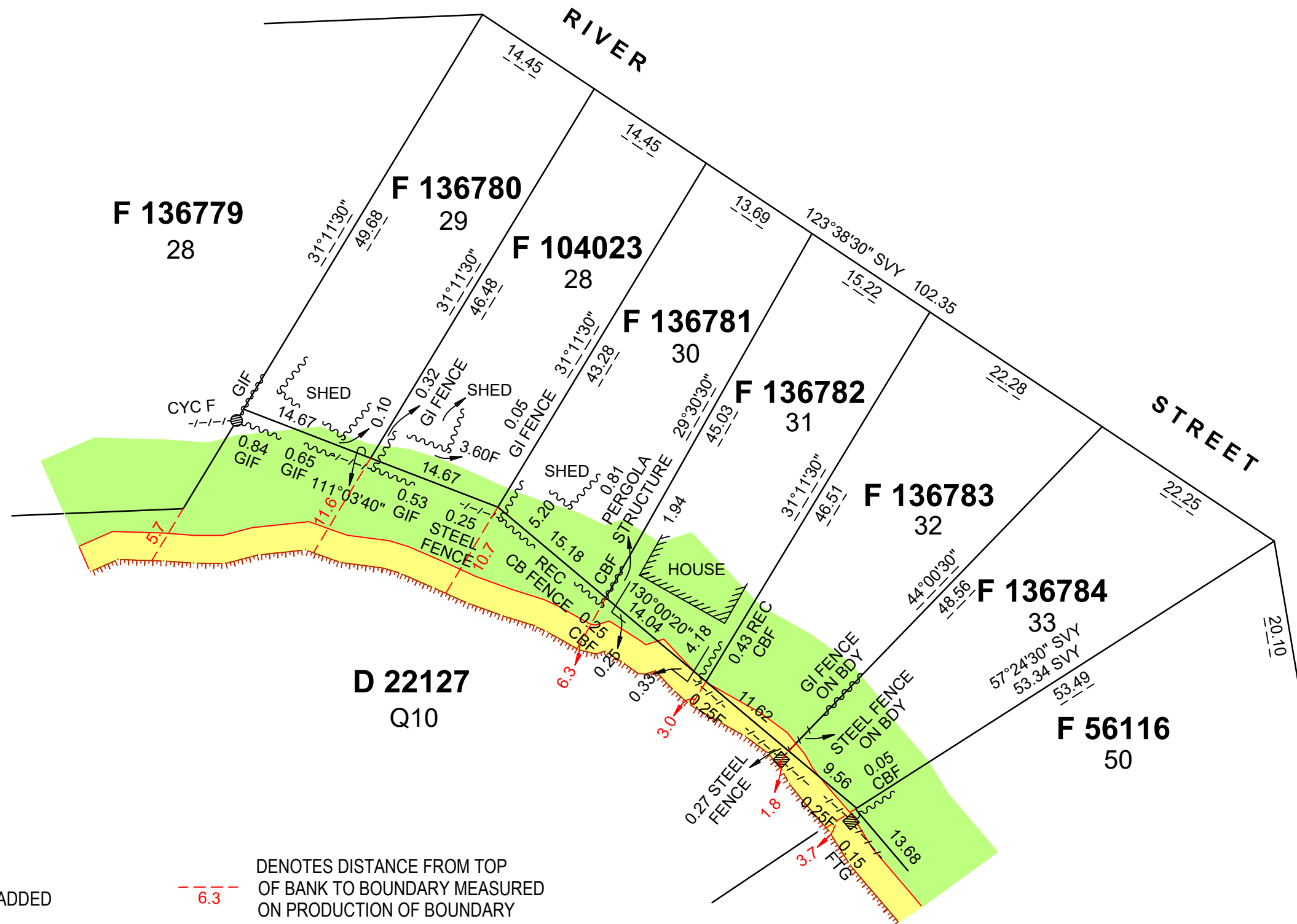
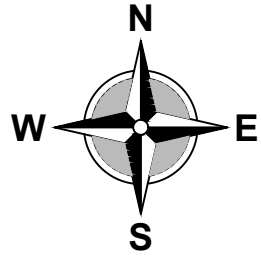



REV B.....18/6/2020....  
 BUFFER ZONES, OFFSETS, ADDITIONAL OCC. ADDED

Alexander & Symonds Pty Ltd  
 11 King William Street Kent Town,  
 South Australia 5067  
 PO Box 1000 Kent Town, SA 5071  
 DX 209 ABN 93007 753 988

**T** (08) 8130 1666  
**F** (08) 8362 0099  
**W** www.alexander.com.au  
**E** adelaide@alexander.com.au

+ Property + Land Development +  
 + Construction + Mining +  
 + Spatial Information Management +

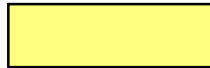

-  TOP OF BANK
-  DENOTES 3m WIDE BUFFER
-  DENOTES 10m WIDE BUFFER

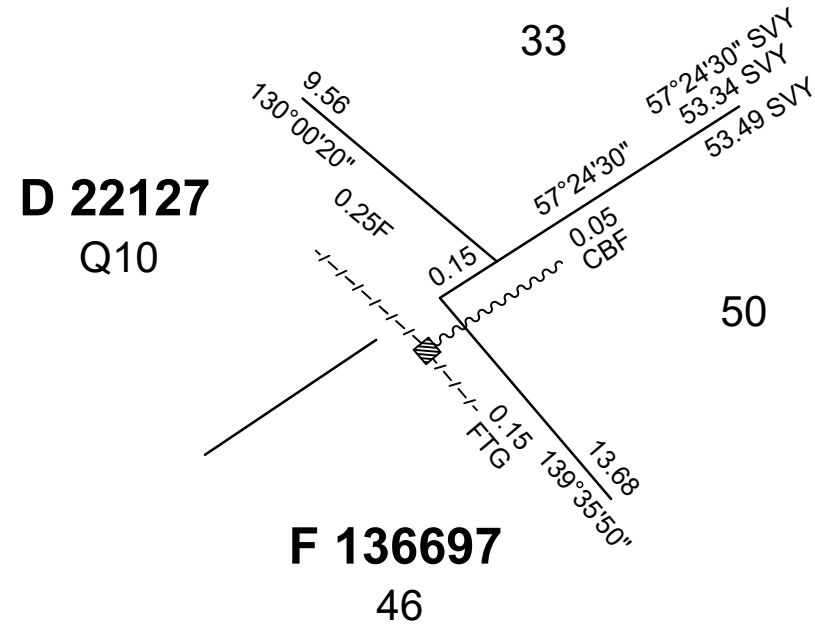
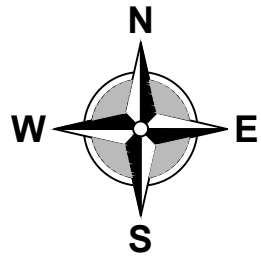

ENLARGEMENT A  
NOT TO SCALE

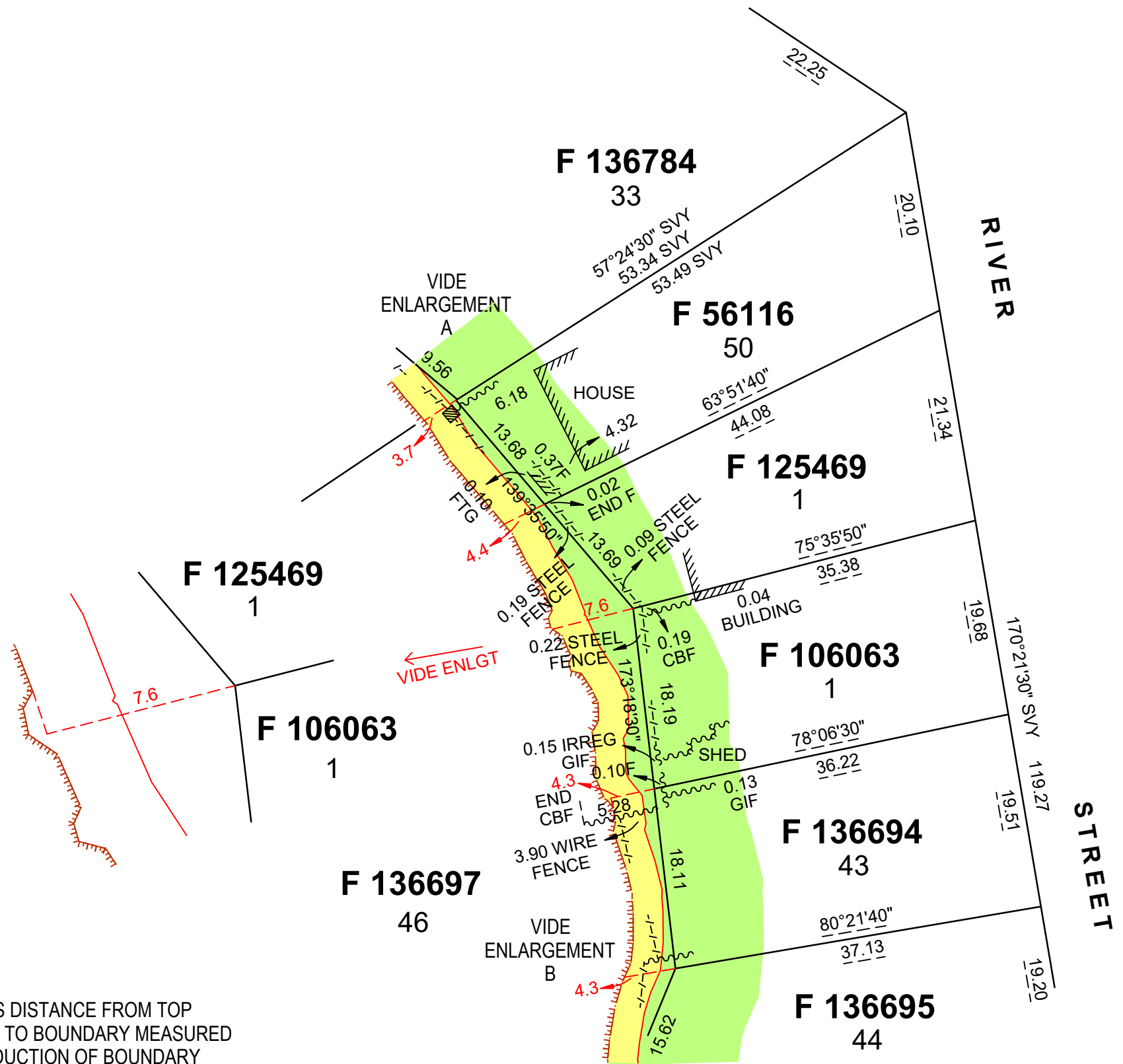

REV B.....18/6/2020....  
BUFFER ZONES, OFFSETS, ADDITIONAL OCC. ADDED

---6.3--- DENOTES DISTANCE FROM TOP OF BANK TO BOUNDARY MEASURED ON PRODUCTION OF BOUNDARY

Alexander & Symonds Pty Ltd  
11 King William Street Kent Town,  
South Australia 5067  
PO Box 1000 Kent Town, SA 5071  
DX 209 ABN 93007 753 988

**T** (08) 8130 1666  
**F** (08) 8362 0099  
**W** www.alexander.com.au  
**E** adelaide@alexander.com.au

+ Property + Land Development +  
+ Construction + Mining +  
+ Spatial Information Management +



--- TOP OF BANK

--- DENOTES 3m WIDE BUFFER

--- DENOTES 10m WIDE BUFFER

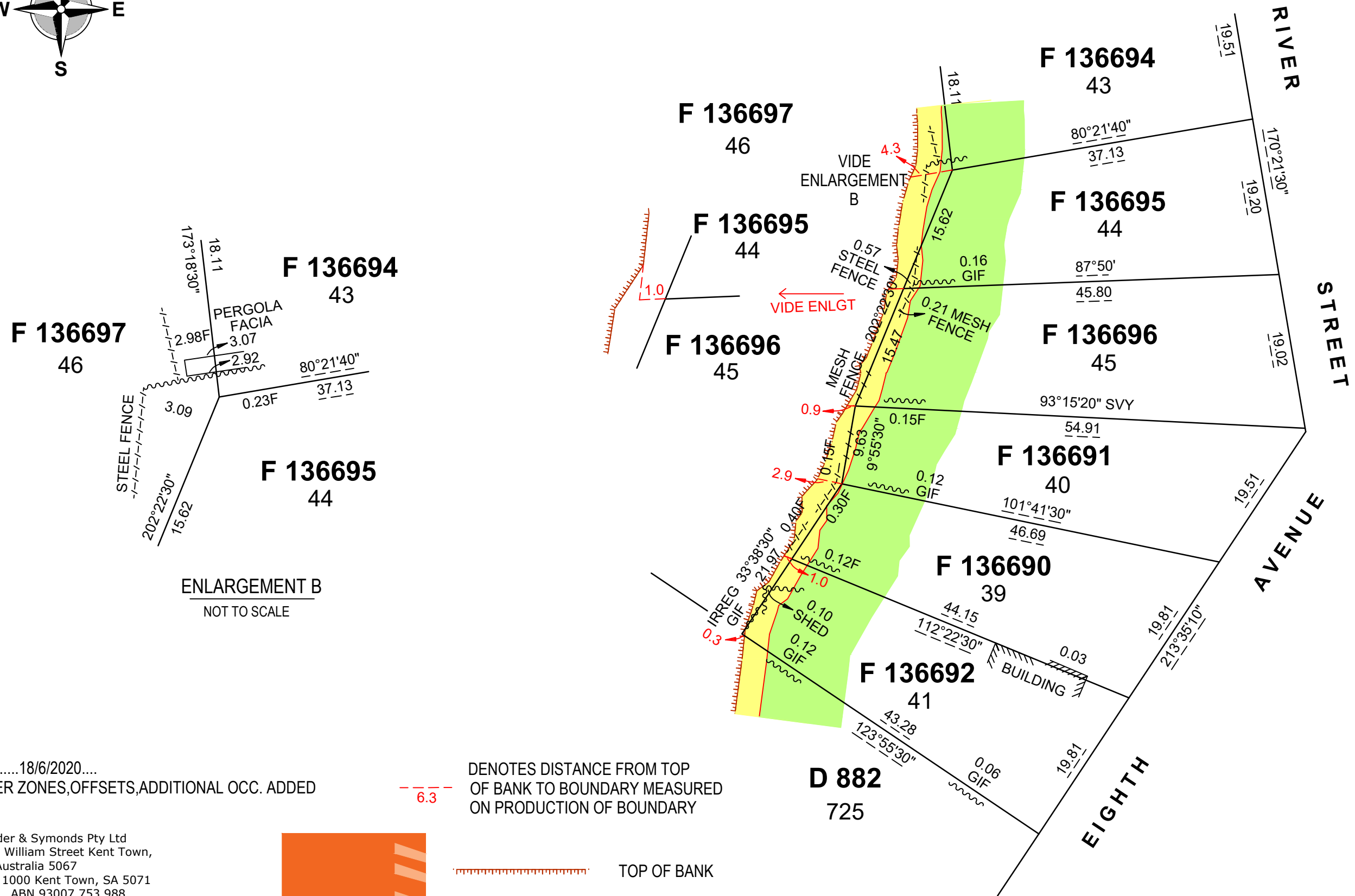
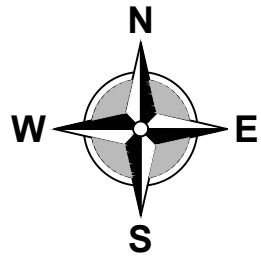

ENLARGEMENT B  
NOT TO SCALE

REV B.....18/6/2020....  
BUFFER ZONES, OFFSETS, ADDITIONAL OCC. ADDED

Alexander & Symonds Pty Ltd  
11 King William Street Kent Town,  
South Australia 5067  
PO Box 1000 Kent Town, SA 5071  
DX 209 ABN 93007 753 988

T (08) 8130 1666  
F (08) 8362 0099  
W www.alexander.com.au  
E adelaide@alexander.com.au

+ Property + Land Development +  
+ Construction + Mining +  
+ Spatial Information Management +



---6.3--- DENOTES DISTANCE FROM TOP  
OF BANK TO BOUNDARY MEASURED  
ON PRODUCTION OF BOUNDARY

--- --- TOP OF BANK

[Yellow Box] DENOTES 3m WIDE BUFFER

[Green Box] DENOTES 10m WIDE BUFFER